

This drawing and the building works defined are the copyright of RPS Planning & Development Ltd and may not be reproduced or transmitted in any form or by any means electronic, mechanical, photocopying, recording, or by any information storage and retrieval system. The Contractor is to comply with all relevant and current Building Regulations, British Standards, Statutory Regulations, Construction Design & Management Regulations, Party Wall Act, and other relevant legislation. The Client will be responsible for ensuring that all relevant legislation is complied with. The Contractor is to ensure that all relevant legislation is complied with. The Contractor is to ensure that all relevant legislation is complied with. The Contractor is to ensure that all relevant legislation is complied with.

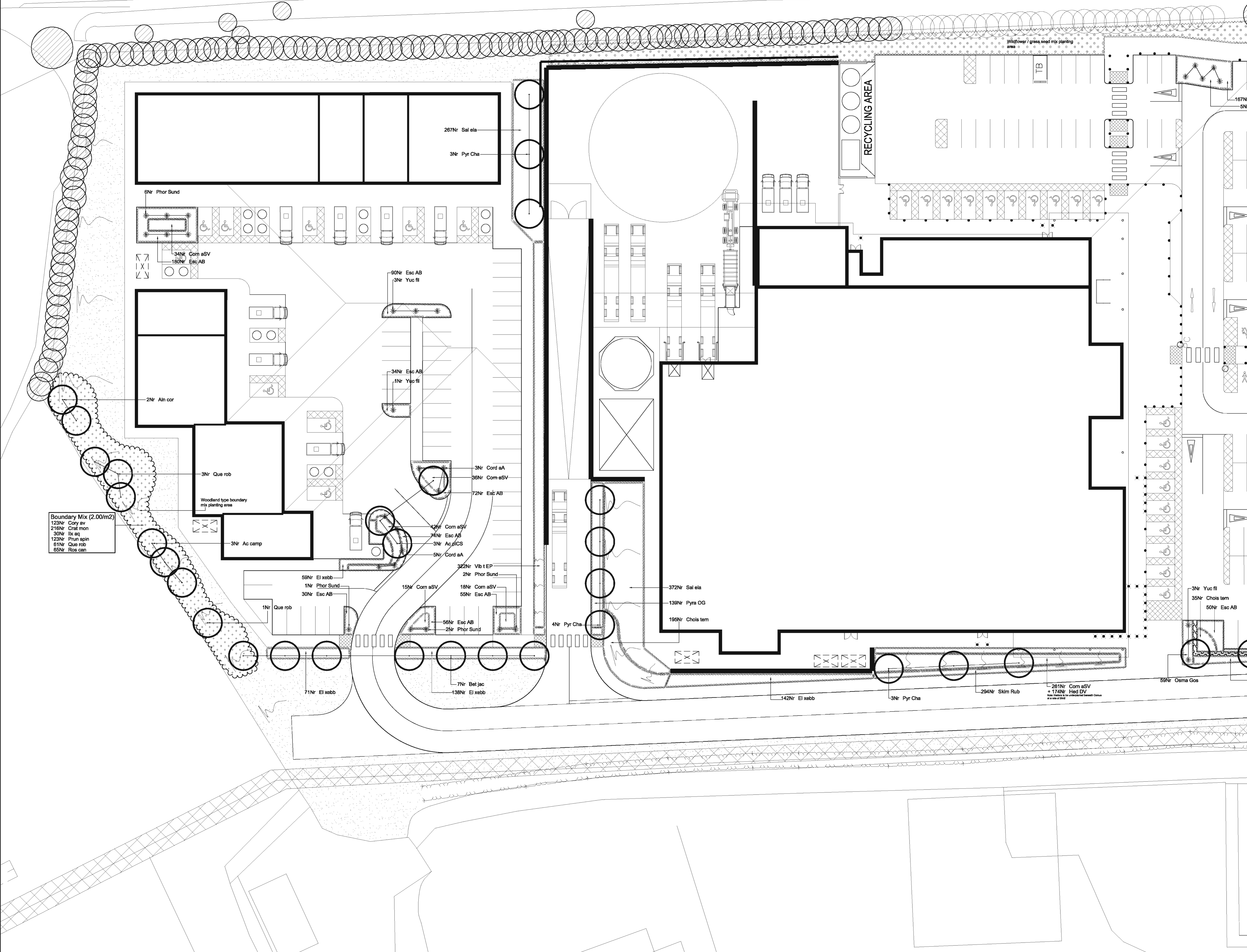

Boundary Mix (2.00m²)
 123Nr Cory av
 216Nr Crat mon
 30Nr Iix an
 123Nr Prun spin
 61Nr Que rob
 65Nr Ros can

Landscape Key:

- Existing trees to be removed (subject to LPA approval)
- Existing trees to be retained
- Proposed tree planting
- Proposed specimen shrub planting
- Proposed ornamental shrub planting
- Proposed shrub hedge planting
- Proposed woodland type boundary mix planting
- Proposed wildflower/grass seed mix planting
- Proposed wildflower/grass seed mix planting
- Proposed 450mm high timber trip rail to be erected where indicated

Revision	Date	Author	Name	Checked

RPS Planning & Development
 Salisbury House, 26 Tisbury Road, Winton, Wiltshire, WY1 4BB
 T 01980 771131 F 01980 421514 E rps@rpsplanning.com W www.rpsplanning.com

Client: ASDA
 Project: New Asda Store, Marsh Lane, Hayle
 Title: Detailed Soft Landscape Proposals (Sheet 1 of 2)

Status: **Planning** Drawn: **DMB** Date: 17.09.2010 Scale: 1:200@A0
 Checked: Drawing Ref:

Job No: **AAR4807** Drg No: **LS:01** Rev:

Architects: Landscape Architects, Engineers: Surveyors, Services Consultants